



# TURNER UNI-DRIVE

22M - MANUAL SHIFT  
22A - AUTOMATIC SHIFT

Ratio range 1.00 - 2.00 : 1  
Torque Capacity - 4250 in-lbs (Manual)  
3000 in-lbs (Automatic)

2 or 3 speeds with manual shift  
2 speeds with automatic shift  
Off-the-shelf components for all ratios  
Available with reversing ratios

Approx. Weight 250 lbs

## DIMENSIONS

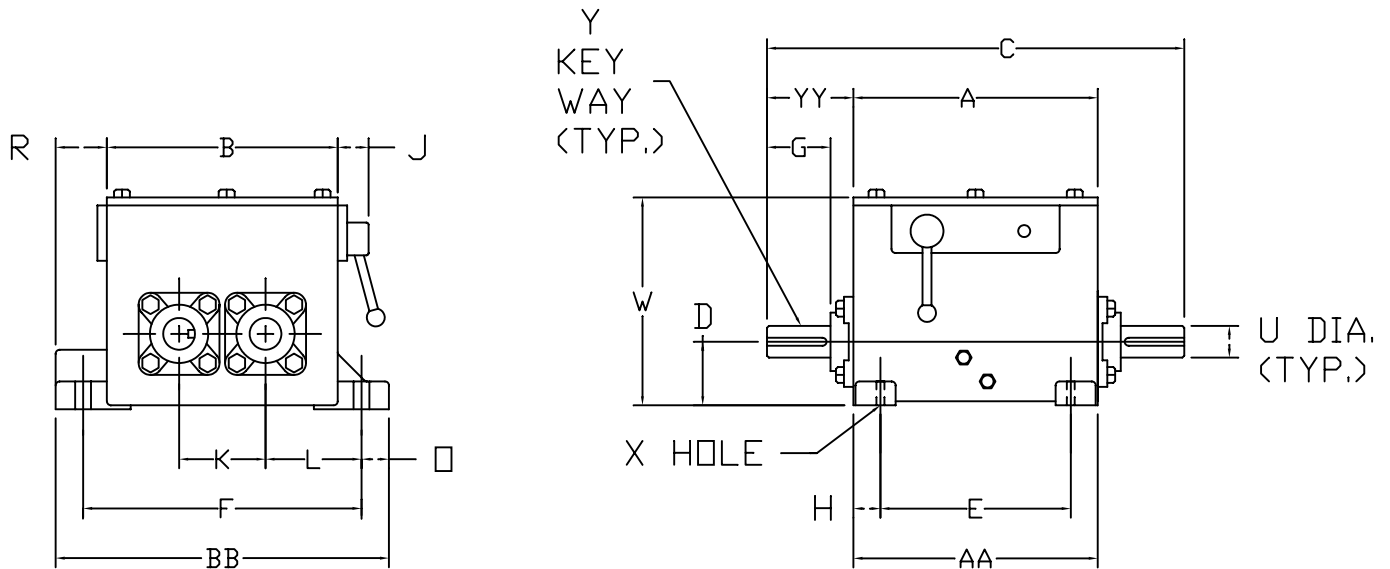

Hinged Motor Plate and Mounting Base available as Optional Accessories.  
Contact TURNER UNI-DRIVE for Dimensions.

A	B	C	D	E	F	G	H	J	K	L
15	13 3/8	27 1/4	4.750	10 3/4	16 3/8	5	2 1/8	2	5.000	5 11/16

□	R	U	W	X	Y
1	2 1/2	2.250	13	7/8 DIA	1/2 X 1/4 X 4 1/2

AA	BB	YY
15	18 3/8	6 1/8

DIMENSIONS ARE IN INCHES AND ARE NOT TO BE USED FOR CONSTRUCTION UNLESS CERTIFIED