



TURNER UNI-DRIVE

52M - MANUAL SHIFT

Ratio range 1.00 - 2.00 : 1
 Torque Capacity - 7240 in-lbs (Standard Gears)
 10860 in-lbs (Special Gears)

2 or 3 speeds with manual shift
 2 speed with automatic shift
 Off-the-shelf components for all ratios
 Available with reversing ratios

Approx. Weight 365 lbs

DIMENSIONS

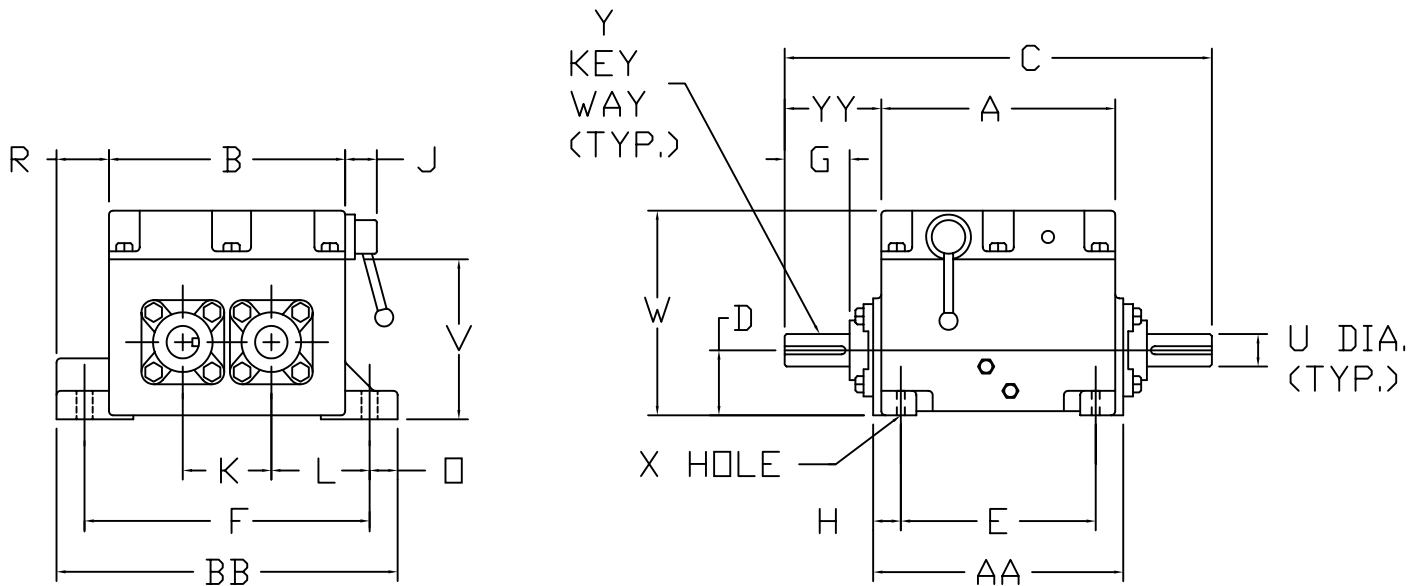

Hinged Motor Plate and Mounting Base available as Optional Accessories.
 Contact TURNER UNI-DRIVE for Dimensions.

A	B	C	D	E	F	G	H	J	K	L
21 1/4	19 3/8	33 1/2	4.250	16 3/4	22 1/8	5	2 1/4	1 7/8	5.000	6 7/16

□	R	U	V	W	X	Y	Z
1 1/8	2 1/2	2.250	8 7/8	12	7/8 DIA	1/2 X 1/4 X 4 1/2	7/8 DIA

AA	BB	YY
21 1/4	24 3/8	21 3/4

DIMENSIONS ARE IN INCHES AND ARE NOT TO BE USED FOR CONSTRUCTION UNLESS CERTIFIED